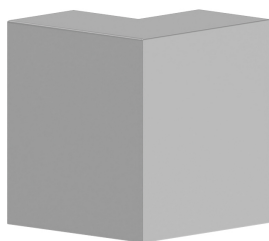

Date: 09.05.2025

## Outer corner BRS 80x170/80, steel, zinc

**Product description**

Outer corner as cut-covering moulded hood for wall duct made of sheet steel, for routing cables around wall projections, with pre-assembled cover for plugging into the bases, side length 170 mm.

**Basic data**

Item number	12604
Product group	20-Wall installation
Packing unit	1 piece
EAN code	4018475269422
Tariff number	73089059

**Technical features**

Width	170 mm
Depth	80 mm
Number of covers	1
Cover width 1	80 mm
Symmetric	yes
Model	moulded hood
Angle	90 - 90 °
Material	steel
Halogen free	yes
Surface protection	pre-galvanised
Colour	other
Mounting method cover	inner lying